

**PR**   
PROPERTY

6A Thornhill Road, Luton, Bedfordshire, LU4 8EY  
£1,000 PCM

- EXCLUSIVE TO P&R PROPERTY LETTINGS
- AVAILABLE FEBRUARY 2026
- ALLOCATED PARKING
- FITTED KITCHEN
- LUXURY FINISH
- MUST BE VIEWED
- TWO BEDROOMS

\*\*\* EXCLUSIVE TO P&R PROPERTY LETTINGS \*\*\* TWO BEDROOM APARTMENT \*\*\* LUXURY MODERN FINISH THROUGHOUT \*\*\* PARKING AVAILABLE \*\*\* FITTED KITCHEN \*\*\* AVAILABLE FEBRUARY 2026 \*\*\* OPEN PLAN LIVING SPACE \*\*\* MUST BE VIEWED \*\*\* CLOSE TO LOCAL TRANSPORT LINKS AND TRAIN STATION \*\*\*

This property benefits from accommodation comprising of entrance hall, kitchen/living area, two bedrooms and bathroom. Property is on the second floor.

#### HALL

Storage cupboard, double door, door to:

#### LIVING ROOM

Window to rear, door to:

#### BEDROOM 1

Window to rear, door to:

#### BEDROOM 2

Window to front, door to:

#### BATHROOM

Window to front, door.

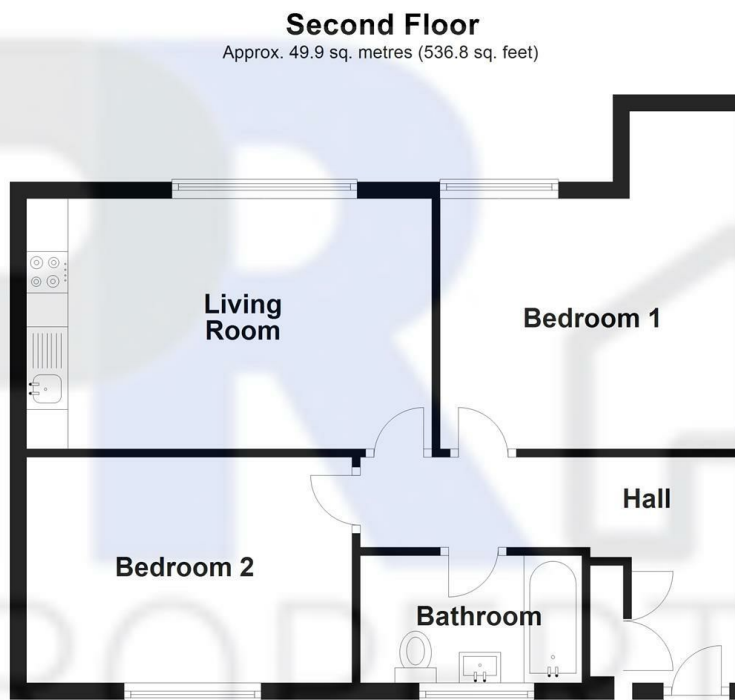

Total area: approx. 49.9 sq. metres (536.8 sq. feet)

**6a Thornhill road**

Energy Efficiency Rating		Current	Potential
Very energy efficient - lower running costs			
(92 plus)	A		
(81-91)	B		
(69-80)	C		
(55-68)	D	65	65
(39-54)	E		
(21-38)	F		
(1-20)	G		
Not energy efficient - higher running costs			
England & Wales		EU Directive 2002/91/EC	